

# Cuillin

4 BEDROOM DETACHED VILLA WITH GARAGE

Artists' impressions are not intended to give an accurate description of any specific property offered for sale, its setting or its surroundings; they are intended to give an impression of the look and feel of different house types to be constructed within the development.

# Cuillin 4 BEDROOM DETACHED VILLA WITH GARAGE

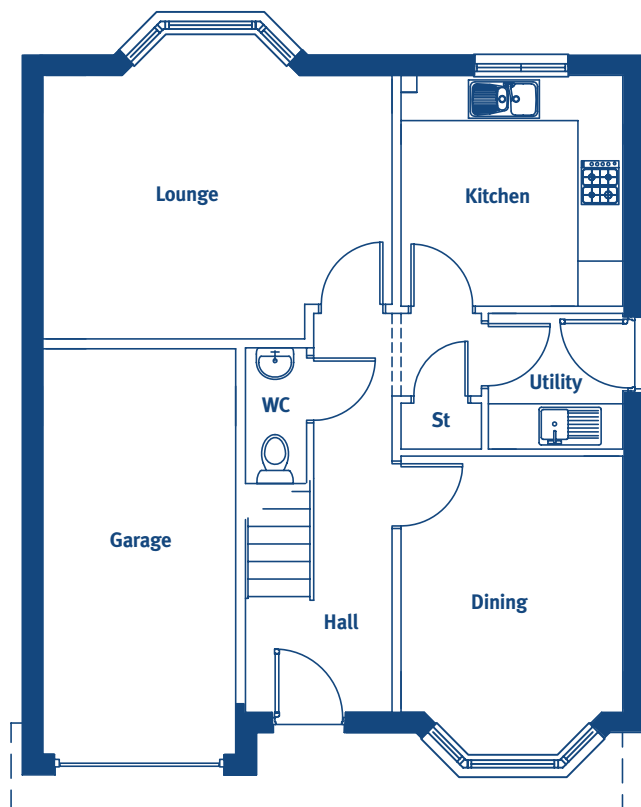

## GROUND FLOOR

<b>LOUNGE</b>	3498mm x 4688mm	11'5 x 15'4
<b>KITCHEN</b>	3065mm x 2972mm	10'0 x 9'9
<b>DINING</b>	3400mm x 2973mm	11'1 x 9'9
<b>UTILITY</b>	1800mm x 1800mm	5'10 x 5'10
<b>WC</b>	1805mm x 805mm	5'10 x 2'7
<b>GARAGE</b>	5388mm x 2593mm	17'8 x 8'6

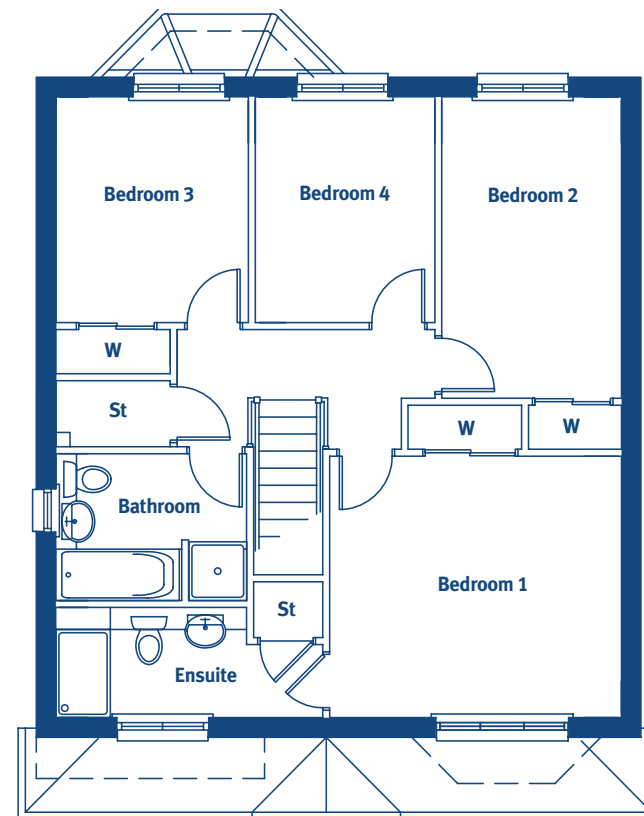

## FIRST FLOOR

<b>BEDROOM 1</b>	3560mm x 4012mm	11'8 x 13'2
<b>ENSUITE</b>	3673mm x 1500mm	12'0 x 4'11
<b>BEDROOM 2</b>	4105mm x 2472mm	13'6 x 8'1
<b>BEDROOM 3</b>	3076mm x 2650mm	10'1 x 8'8
<b>BEDROOM 4</b>	3075mm x 2470mm	10'1 x 8'1
<b>BATHROOM</b>	2000mm x 2625mm	6'7 x 8'7

The dimensions shown on the floor plans of all our homes are approximate; each home is built individually and so the precise measurements may vary from those shown although every effort is made to make the dimensions as accurate as possible. We give maximum dimensions that include fitted wardrobes, sloping ceilings, bay windows, and any other features. The measurements should not be relied upon for ordering or fitting carpets, floor coverings or any other fitted goods.

tel 01259 729101 visit [allanwater.co.uk](http://allanwater.co.uk)

**Allanwater**  
HOMES