

Kintail

3 BEDROOM TERRACED VILLA

Artists' impressions are not intended to give an accurate description of any specific property offered for sale, its setting or its surroundings; they are intended to give an impression of the look and feel of different house types to be constructed within the development.

Kintail 3 BEDROOM TERRACED VILLA

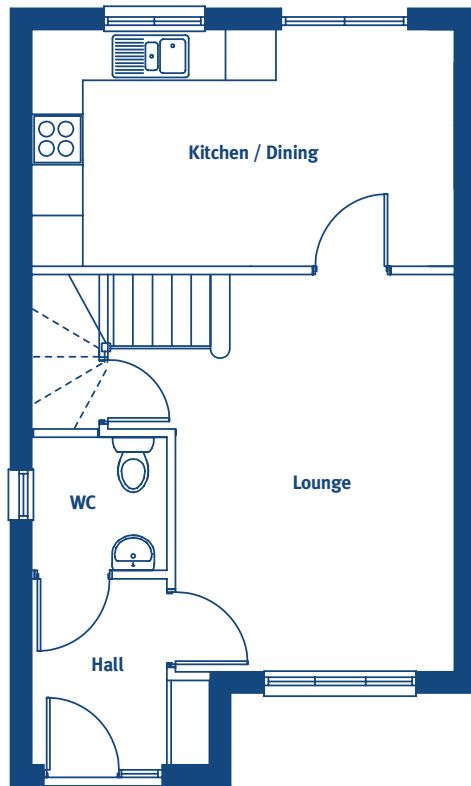

GROUND FLOOR

LOUNGE	4700mm x 3300mm	15'5 x 10'10
KITCHEN/DINING	2800mm x 5000mm	9'2 x 16'5
WC	1574mm x 1600mm	5'2 x 5'3

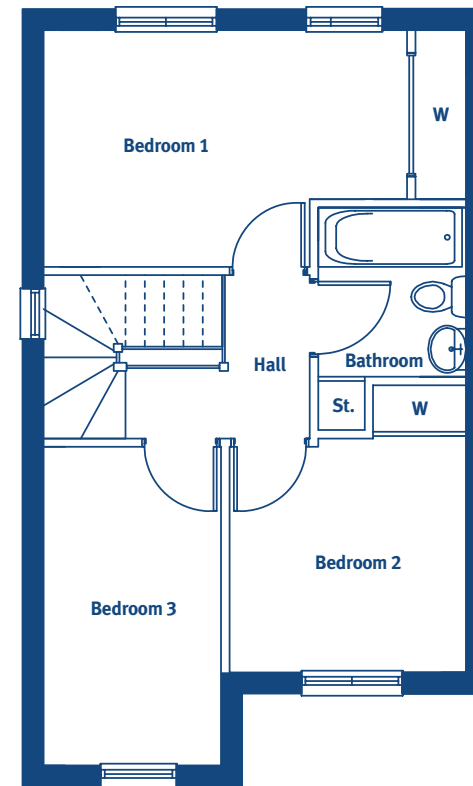

FIRST FLOOR

BEDROOM 1	2800mm x 4300mm	9'2 x 14'1
BEDROOM 2	2799mm x 2800mm	9'2 x 9'2
BEDROOM 3	3769mm x 2100mm	12'4 x 6'11
BATHROOM	2000mm x 1750mm	6'7 x 5'9

The dimensions shown on the floor plans of all our homes are approximate; each home is built individually and so the precise measurements may vary from those shown although every effort is made to make the dimensions as accurate as possible. We give maximum dimensions that include fitted wardrobes, sloping ceilings, bay windows, and any other features. The measurements should not be relied upon for ordering or fitting carpets, floor coverings or any other fitted goods.

tel 01259 729101 visit allanwater.co.uk

Allanwater
HOMES