



Ochil

4 BEDROOM DETACHED VILLA WITH GARAGE

Artists' impressions are not intended to give an accurate description of any specific property offered for sale, its setting or its surroundings; they are intended to give an impression of the look and feel of different house types to be constructed within the development.

Ochil 4 BEDROOM DETACHED VILLA WITH GARAGE

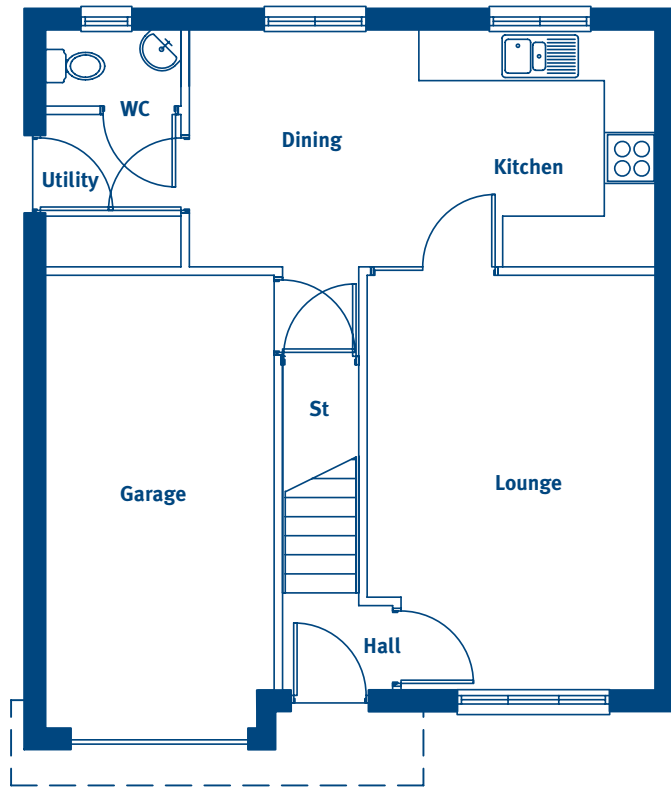

GROUND FLOOR

LOUNGE	5003mm x 3365mm	16'5 x 11'0
KITCHEN/DINING	2770mm x 5373mm	7'5 x 17'7
UTILITY	1775mm x 1750mm	5'10 x 5'9
WC	900mm x 1750mm	2'11 x 5'9
GARAGE	5553mm x 2650mm	18'3 x 18'8

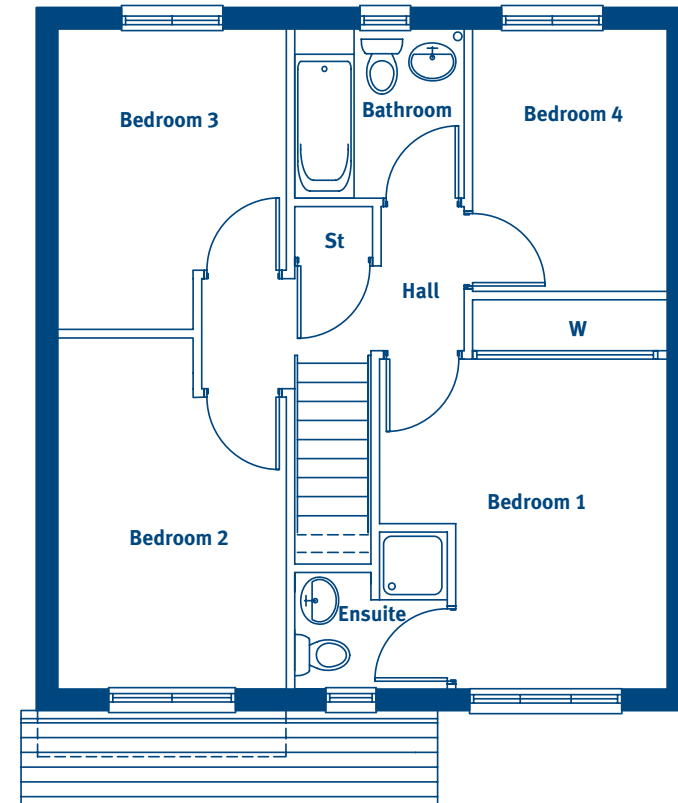

FIRST FLOOR

BEDROOM 1	3950mm x 2495mm	12'12 x 8'2
ENSUITE	1873mm x 1845mm	6'2 x 6'1
BEDROOM 2	4253mm x 2687mm	13'11 x 8'10
BEDROOM 3	3545mm x 2687mm	11'8 x 8'10
BEDROOM 4	3248mm x 2300mm	10'8 x 7'7
BATHROOM	2000mm x 2040mm	6'7 x 6'8

The dimensions shown on the floor plans of all our homes are approximate; each home is built individually and so the precise measurements may vary from those shown although every effort is made to make the dimensions as accurate as possible. We give maximum dimensions that include fitted wardrobes, sloping ceilings, bay windows, and any other features. The measurements should not be relied upon for ordering or fitting carpets, floor coverings or any other fitted goods.

tel 01259 729101 visit allanwater.co.uk

Allanwater
HOMES